

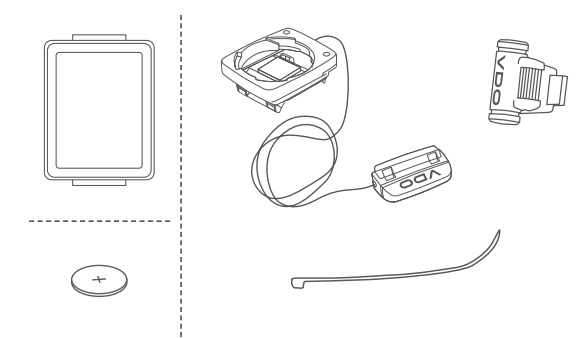

www.vdocyclecomputing.com/service

SIGMA-ELEKTRO GmbH
Dr.-Julius-Leber-Straße 15
67433 Neustadt/Weinstrasse (Germany)
www.vdocyclecomputing.com

Verpackungsinhalt/Content M1.1/M2.1



Verpackungsinhalt/Content M1.1 WL/M2.1 WL

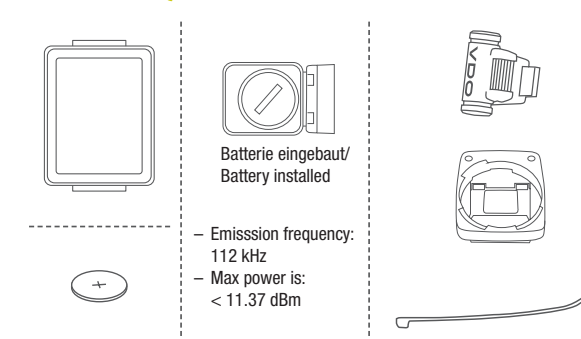

Montage M1.1 / M2.1
Montage Lenkerhalterung / Installation of handlebar mount

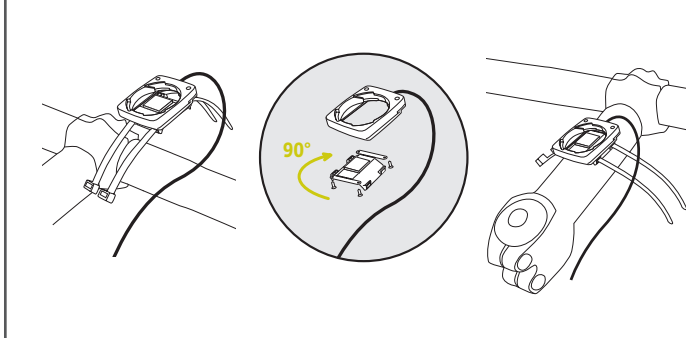

Montage M1.1 WL / M2.1 WL
Montage Lenkerhalterung / Installation of handlebar mount

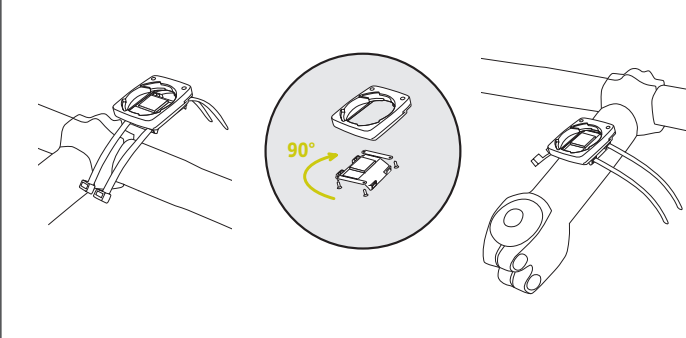

Montage Funk-Sender / Installation wireless transmitter

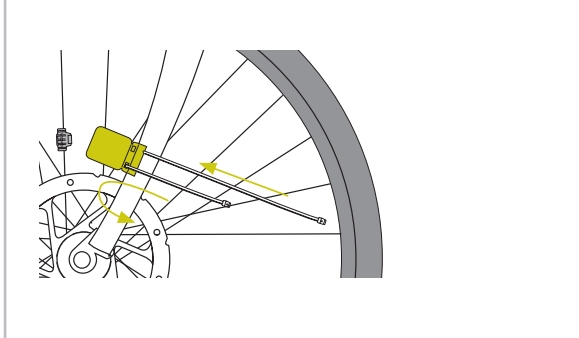

Montage Funk-Sender / Installation wireless transmitter

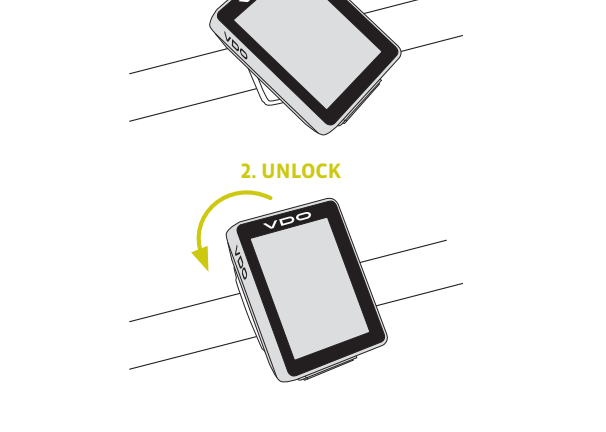
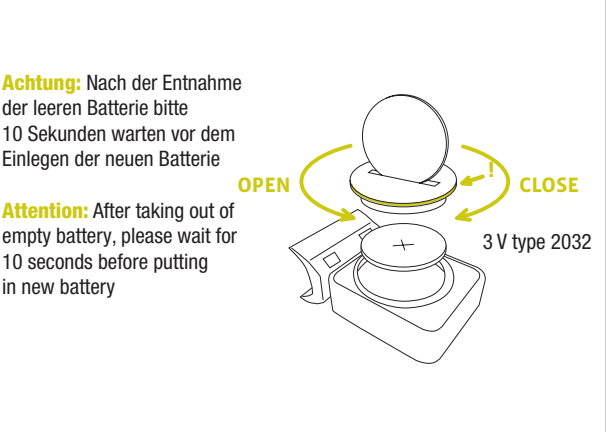
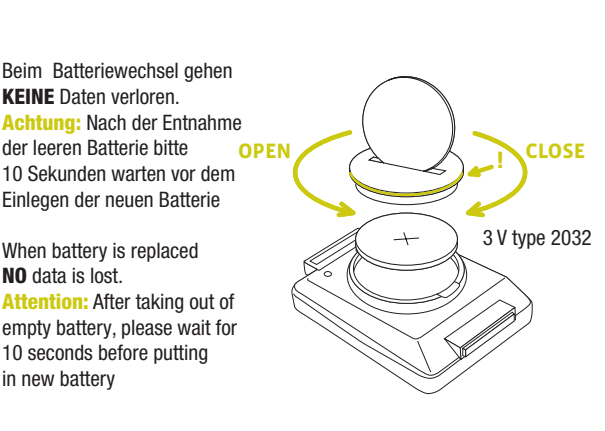
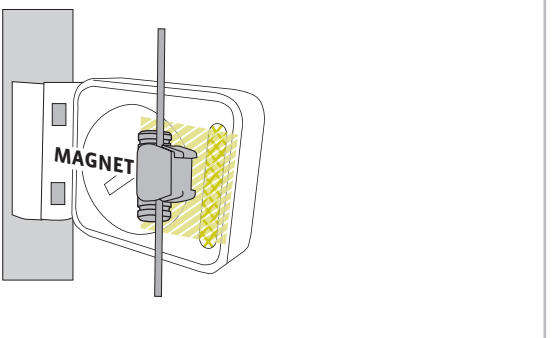

Die Einstellungen

Die SET-Taste gedrückt halten um in das Einstell-Menü zu gelangen.
Mit der BIKE-Taste blättert man von Einstellung zu Einstellung.
Um in die ausgewählte Einstellung zu gelangen die SET-Taste kurz drücken.

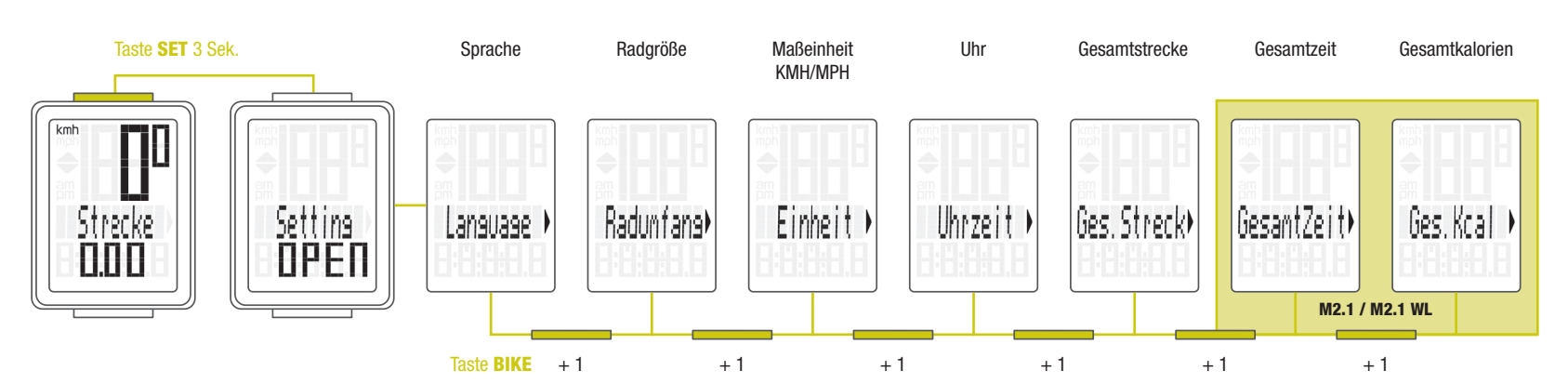

Abruf der Funktionen

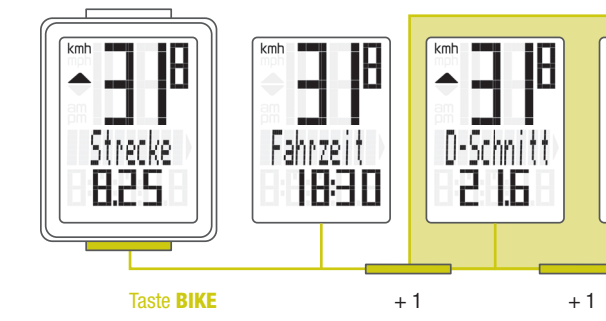

Korrekte Entsorgung dieses Produkts (Elektronik)

(Anzuwenden in den Ländern der Europäischen Union und anderen europäischen Ländern mit einem separaten Sammel-System) Die Kennzeichnung auf dem Produkt bzw. auf der dazugehörigen Literatur gibt an, dass es nach seiner Lebensdauer nicht zusammen mit dem normalen Hausabfall entsorgt werden darf.

EU-Konformitätserklärung

Wir, SIGMA-ELEKTRO GmbH, Dr.-Julius-Leber-Straße 15, erklären, dass der VDO Fahrradcomputer mit Funkübertragung VDO M1.1 WL, M2.1 WL und der Sender A1 Speed bei bestimmungsgemäßer Verwendung den grundlegenden Anforderungen gemäß RED Directive 2014/53/EU und der RoHS Directive 2011/65/EU entsprechen.

EU-Konformitätserklärung

Wir, SIGMA-ELEKTRO GmbH, Dr.-Julius-Leber-Straße 15, erklären, dass der VDO Fahrradcomputer VDO M1.1 WL, M2.1 WL bei bestimmungsgemäßer Verwendung den grundlegenden Anforderungen gemäß EMC Directive 2014/30/EU und der RoHS Directive 2011/65/EU entsprechen.

Icons

Nur M2.1 und M2.1 WL
Vergleich der aktuellen Geschwindigkeit mit der Durchschnitts-Geschwindigkeit

Tour Daten auf Null zurückstellen



Stand-By Modus für Funkempfänger

M1.1 WL und M2.1 WL haben einen Stand-By-Modus für den Funkempfänger. Der Empfänger bleibt bei einer Pause für 2 Stunden aktiv.

Batteriewarnung

Bestätigen Sie die Batteriewarnung mit der BIKE-Taste. Ersetzen Sie möglichst bald die schwache Batterie.

Garantiebedingungen

SIGMA-ELEKTRO GmbH gewährt für ihren VDO-Computer eine Garantie von 2 Jahren ab Kaufdatum. Die Garantie erstreckt sich auf Material- und Verarbeitungsfehler am Computer selbst.

Correct Disposal of This Product (Waste Electrical & Electronic Equipment)

(Applicable in the European Union and other European countries with separate collection systems) This marking shown on the product or its literature, indicates that it should not be disposed with other household wastes at the end of its working life.

EU-Declaration of Conformity

Wir, SIGMA-ELEKTRO GmbH, Dr.-Julius-Leber-Straße 15 declare under our responsibility that the product VDO M1.1 WL, M2.1 WL is compliant with the essential requirements of the EMC Directive 2014/30/EU and the RoHS Directive 2011/65/EU.

EU-Declaration of Conformity

Wir, SIGMA-ELEKTRO GmbH, Dr.-Julius-Leber-Straße 15 declare under our responsibility that the product VDO M1.1 WL, M2.1 WL is compliant with the essential requirements of the EMC Directive 2014/30/EU and the RoHS Directive 2011/65/EU.

Settings

Press and hold the SET button to access the settings menu. Press the BIKE button to move from setting to setting. Press the SET button to start to the selected setting.

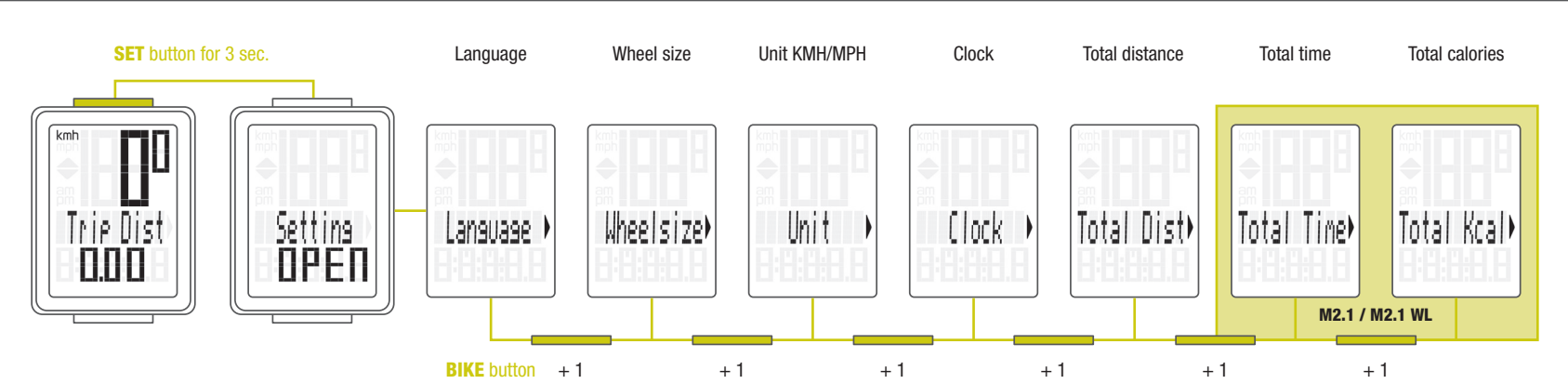

Accessing functions

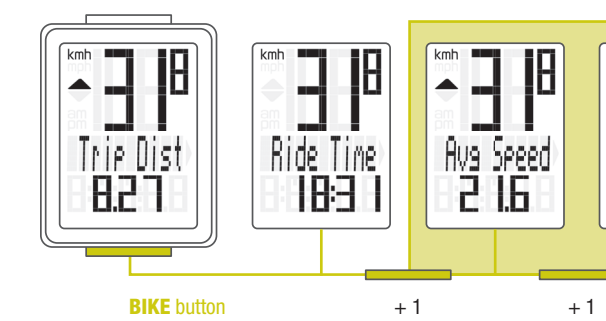

Correct Disposal of This Product (Waste Electrical & Electronic Equipment)

(Applicable in the European Union and other European countries with separate collection systems) This marking shown on the product or its literature, indicates that it should not be disposed with other household wastes at the end of its working life.

EU-Declaration of Conformity

Wir, SIGMA-ELEKTRO GmbH, Dr.-Julius-Leber-Straße 15 declare under our responsibility that the product VDO M1.1 WL, M2.1 WL is compliant with the essential requirements of the EMC Directive 2014/30/EU and the RoHS Directive 2011/65/EU.

EU-Declaration of Conformity

Wir, SIGMA-ELEKTRO GmbH, Dr.-Julius-Leber-Straße 15 declare under our responsibility that the product VDO M1.1 WL, M2.1 WL is compliant with the essential requirements of the EMC Directive 2014/30/EU and the RoHS Directive 2011/65/EU.

Icons

M2.1 and M2.1 WL only
Comparison of the current speed and the average speed

Reset trip data to zero

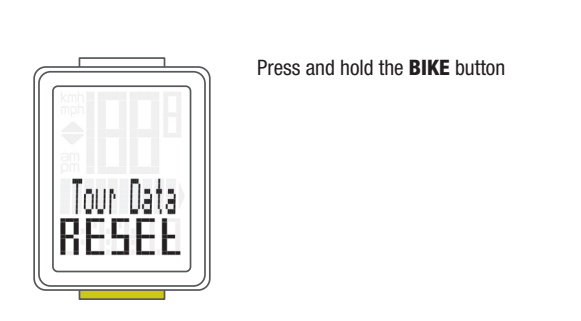

Standby mode for wireless receiver

M1.1 WL and M2.1 WL have a stand-by mode for the wireless receiver. The receiver remains active for 2 hours during a break.

Low battery warning

Acknowledge the low battery warning by pressing the BIKE button. Replace the low battery as soon as possible.

Terms of guarantee

SIGMA-ELEKTRO GmbH offers a 2-year guarantee on your VDO computer, starting from date of purchase. This guarantee covers material and processing defects on the computer itself.

Correct Disposal of This Product (Waste Electrical & Electronic Equipment)

(Applicable in the European Union and other European countries with separate collection systems) This marking shown on the product or its literature, indicates that it should not be disposed with other household wastes at the end of its working life.

EU-Declaration of Conformity

Wir, SIGMA-ELEKTRO GmbH, Dr.-Julius-Leber-Straße 15 declare under our responsibility that the product VDO M1.1 WL, M2.1 WL is compliant with the essential requirements of the EMC Directive 2014/30/EU and the RoHS Directive 2011/65/EU.

EU-Declaration of Conformity

Wir, SIGMA-ELEKTRO GmbH, Dr.-Julius-Leber-Straße 15 declare under our responsibility that the product VDO M1.1 WL, M2.1 WL is compliant with the essential requirements of the EMC Directive 2014/30/EU and the RoHS Directive 2011/65/EU.

Réglages

Maintenir la touche SET enfoncée pour accéder au menu "Réglages". La touche BIKE permet de passer d'un réglage à l'autre. Appuyer brièvement sur la touche SET pour accéder au réglage souhaité.

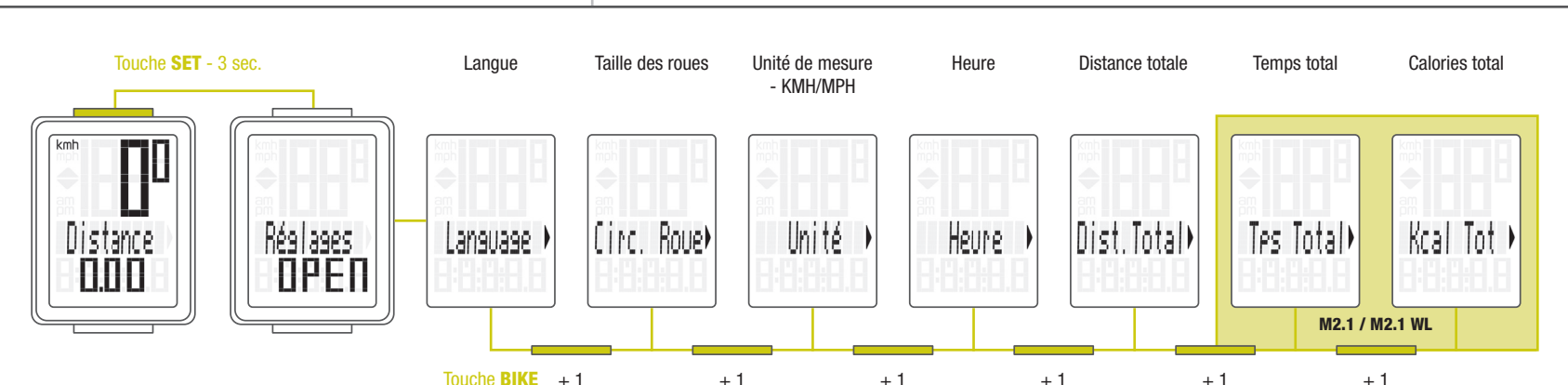

Appel des fonctions

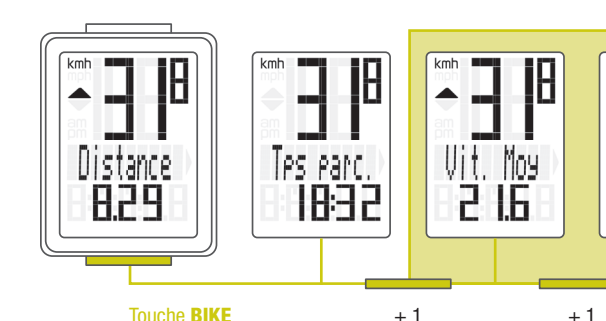

Comment éliminer ce produit (déchets d'équipements électriques et électroniques)

(Applicable dans les pays de l'Union Européenne et aux autres pays européens disposant de systèmes de collecte sélective) Ce symbole sur le produit ou sa documentation indique qu'il ne doit pas être éliminé en fin de vie avec les autres déchets ménagers.

EU-Declaration of Conformity

Wir, SIGMA-ELEKTRO GmbH, Dr.-Julius-Leber-Straße 15 declare under our responsibility that the product VDO M1.1 WL, M2.1 WL is compliant with the essential requirements of the EMC Directive 2014/30/EU and the RoHS Directive 2011/65/EU.

EU-Declaration of Conformity

Wir, SIGMA-ELEKTRO GmbH, Dr.-Julius-Leber-Straße 15 declare under our responsibility that the product VDO M1.1 WL, M2.1 WL is compliant with the essential requirements of the EMC Directive 2014/30/EU and the RoHS Directive 2011/65/EU.

Ícônes

M2.1 et M2.1 WL uniquement
Comparison de la vitesse actuelle et de la vitesse moyenne

Remettre les données du tour à zéro

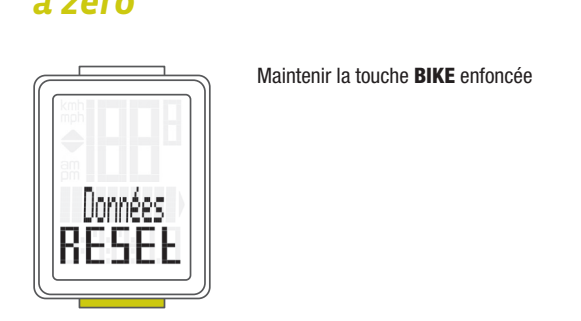

Mode de veille pour le récepteur radio

Les M1.1 WL et M2.1 WL sont dotés d'un mode de veille pour le récepteur radio. Le récepteur reste actif pendant 2 heures en cas de pause.

Avertissement "Pile"

Confirmez l'avertissement "Pile" avec la touche BIKE. Remplacez le plus rapidement possible la pile faible.

Conditions de garantie

SIGMA-ELEKTRO GmbH offre une garantie de 2 ans à compter de la date d'achat pour votre ordinateur VDO. La garantie porte sur les défauts de matériel ou les erreurs de traitement sur le logiciel lui-même.

Correct Disposal of This Product (Waste Electrical & Electronic Equipment)

(Applicable in the European Union and other European countries with separate collection systems) This marking shown on the product or its literature, indicates that it should not be disposed with other household wastes at the end of its working life.

EU-Declaration of Conformity

Wir, SIGMA-ELEKTRO GmbH, Dr.-Julius-Leber-Straße 15 declare under our responsibility that the product VDO M1.1 WL, M2.1 WL is compliant with the essential requirements of the EMC Directive 2014/30/EU and the RoHS Directive 2011/65/EU.

EU-Declaration of Conformity

Wir, SIGMA-ELEKTRO GmbH, Dr.-Julius-Leber-Straße 15 declare under our responsibility that the product VDO M1.1 WL, M2.1 WL is compliant with the essential requirements of the EMC Directive 2014/30/EU and the RoHS Directive 2011/65/EU.

